



UNIT 1 VALENTINES BUILDING
AINTREE RACECOURSE
BUSINESS PARK
AINTREE
LIVERPOOL
L9 5AY

JEWEL
HOLE IN THE WALL
Horizon trim version
DECORATIVE FUEL EFFECT GAS FIRE
THIS APPLIANCE IS CAT I_{2H}
FOR USE WITH NATURAL GAS
ONLY
G20 AT 20mbar
IN G.B. AND I.E.

USERS
INSTALLATION & SERVICING
BOOK

INDEX

FRONT COVER	
2. INDEX	
3. TECHNICAL DATA	
4. INSTALLATION GENERAL	
5. HEARTH	
6. INSTALLATION	
7. BESPOKE FIRETRAY INSTALLATION CRITERIA	
8. FIRETRAY SIZES	
9. FIG A	
10. INSTALLATION	
11. INSTALLATION /ODS/ SERVICING	
15 USERS INSTRUCTIONS	
19. FUEL LAYOUT	

PLEASE READ THESE INSTRUCTIONS CAREFULLY BEFORE YOU START
INSTALLING THE APPLIANCE KEEP THIS BOOKLET HANDY FOR FUTURE
REFERENCE

.....BOX SIZES.....

technical data horizon trim

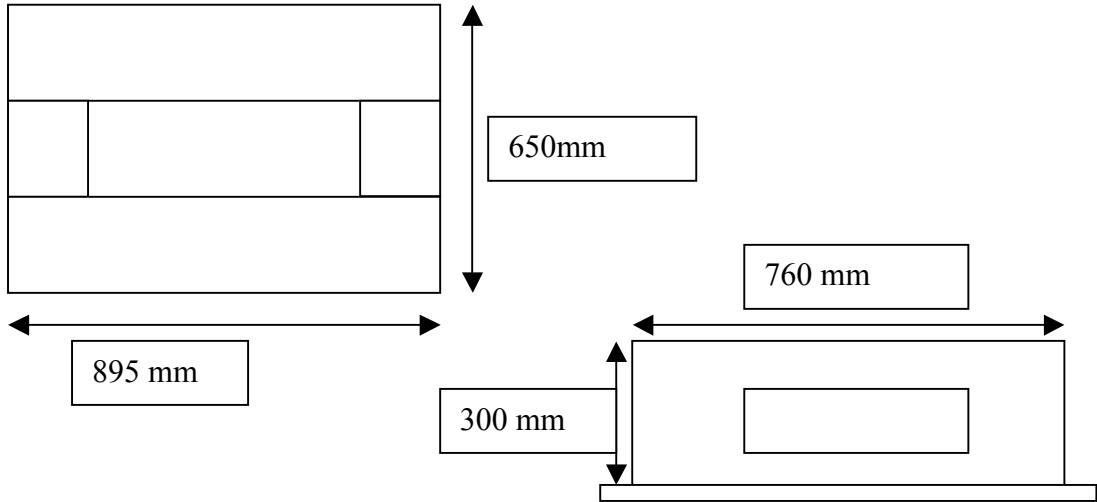

TRIMS available in black stone or brushed steel

IT IS HIGHLY RECCOMENDED A FLUE LINER IS INSTALLED WITH THIS APPLIANCE USING A CRYSTAL FIRES GATHER HOOD IF THE FLUE IS NOT NEW

GAS TYPE: G20 NATURAL
GAS PRESSURE : 20 MBAR
CONNECTION: 8mm OD TUBE
SPARK GAP: 2.5-4mm

INJECTOR : REMOTE TYPE CAT 82/500
HEAT INPUT (GROSS)
HIGH : 6.9kW
LOW : 4.1kW

CAT: 1_{2H}
DATA LABEL LOCATION FRONT BOTTOM SECTION OF APPLIANCE

INSTALLATION GENERAL

IMPORTANT NOTES

THE JEWEL HIW IS DESIGNED AND TESTED TO THE REQUIREMENTS OF BSEN509:2000 AND IS FITTED WITH AN ATMOSPHERE SENSING DEVICE

THE JEWEL SUNRISE CAN ONLY BE USED IN CONJUNCTION WITH A CONVENTIONAL CLASS 1 FLUE OR A 5" FLUE LINER WHEN INSTALLED WITH A CRYSTAL FLUE SPIGOT SHOWN IN FIG a

A NON COMBUSTABLE HEARTH MUST BE PROVIDED TO COMPLY WITH THE BUILDING REGULATIONS OR A SUITABLE PROPRIETARY FIRE SURROUND WITH A 100 DEGREES C RATING.

UNLESS INSTALLED 300mm ABOVE FLOOR LEVEL (SEE SEPARATE PAGE)

THE CHIMNEY OR FLUE (UNLESS NEW) MUST BE SWEEPED BEFORE INSTALLATION IF IT HAS BEEN USED FOR SOLID FUEL

* INSTALLER

THE APPLIANCE MUST BE INSTALLED BY A COMPETENT PERSON , IE A CORGI REGISTERED INSTALLER IN ACCORDANCE WITH THE CURRENT GAS SAFETY (INSTALLATION AND USE) REGULATIONS 1994 OR THE RULES IN FORCE. FAILURE TO DO SO COULD LEAD TO PROSECUTION

*REGULATIONS

THE FOLLOWING ARE THE RELEVANT CODES OF PRACTICE AND BRITISH STANDARDS :

BS5781 PART 2 AND 3 1991 BS8303 1986 BS 5440 PART 1 1990 BS 6891 1988 BS 6461 PARTS 1 & 2 1984 BS 715 1989

THE BUILDING REGULATIONS ISSUED BY THE DEPARTMENT OF THE ENVIRONMENT THE BUILDING STANDARDS (SCOTLAND) (CONSOLIDATION) REGULATIONS ISSUED BY THE SCOTTISH DEVELOPMENT OFFICE

*VENTILATION

GREAT BRITAIN

NO SPECIAL VENTILATION BRICKS OR VENTS ARE NORMALLY REQUIRED INTO THE ROOM CONTAINING THE APPLIANCE, PROVIDED NORMAL ADVENTITIOUS ROOM VENTILATION EXISTS. THE INSTALLER MUST SATISFY THIS POINT BY CARRYING OUT A MANDATORY SPILLAGE TEST.

IRELAND

PURPOSE PROVIDED VENTILATION MUST BE PROVIDED AND MUST HAVE A MINIMUM FREE AREA OF 100CM²

*WARNING

THIS APPLIANCE HAS A NAKED FLAME, AS WITH ALL SUCH FIRES IT IS RECOMMENDED THAT A FIREGUARD SHOULD BE USED FOR THE PROTECTION OF CHILDREN, THE ELDERLY AND INFIRM. FIRE GUARDS SHOULD CONFORM TO BS8423 (FIREGUARDS FOR FIRES AND HEATING APPLIANCES FOR DOMESTIC USE-SPECIFICATION)

USERS INSTALLATION AND SERVICING INSTRUCTIONS

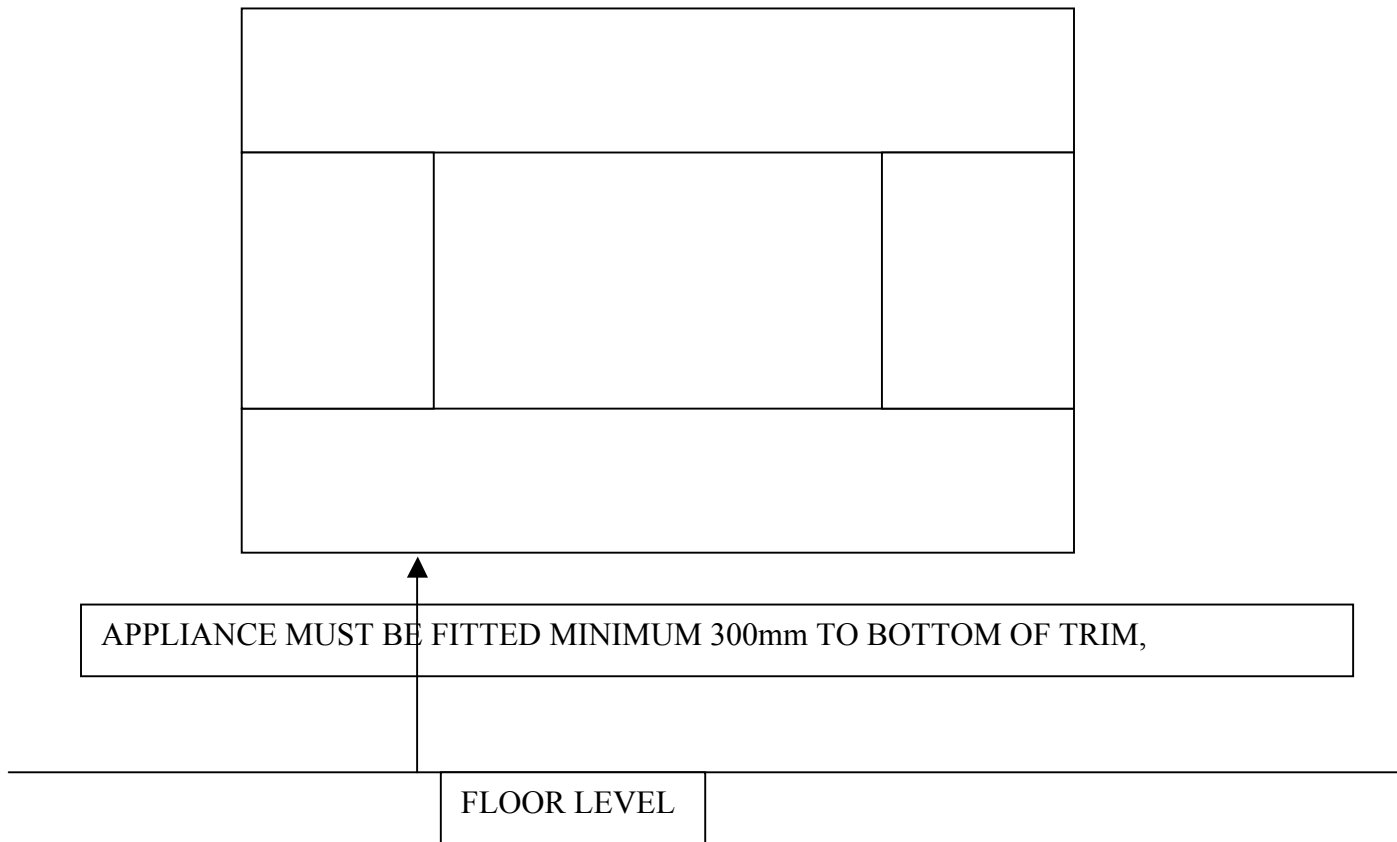

HEARTH
NO PURPOSE MADE HEARTH IS
REQUIRED WITH THIS GAS
APPLIANCE PROVIDING
IT IS WALL MOUNTED AT A
MINIMUM HEIGHT OF 300mm
TO THE BOTTOM OF THE
APPLIANCE TRIM

INSTALLATION REQUIREMENTS

LOCATION AND FLUES

CONVENTIONAL CHIMNEY

A CONVENTIONAL BRICK OR STONE CHIMNEY AS USED FOR A SOLID FUEL APPLIANCE WITH A MINIMUM EFFECTIVE CROSS SECTIONAL DIMENSION OF 225 * 225mm(9 * 9 ins)WITH A MINIMUM OF 3 METRES EFFECTIVE HEIGHT.

A LINED FLUE WITH A MINIMUM DIAMETER OF 175 mm(7ins), OR A LINED FLUE WITH A MINIMUM DIAMETER OF 125mm when used with a crystal fires flue spigot.see fig.a

UNDER NO CIRCUMSTANCES MUST A 125mm LINER BE USED WITHOUT THE CRYSTAL FIRES FLUE SPIGOT

THE CHIMNEY MUST BE SWEEPED PRIOR TO INSTALLATION IF NOT NEW

NOTE.

THE FLUE MUST NOT BE RESTRICTED BY DAMPERS OR REGISTER PLATES.THE FLUE MUST SERVE ONLY ONE APPLIANCE AND NOT HAVE ANY BRANCHES OR TRAPS WHICH MAY IMPEDE THE NATURAL DRAUGHT.IF ANY TERMINAL IS FITTED IT MUST BE SUITABLE FOR THE PURPOSE.

HEARTH.IF INSTALLED BELOW 300mm

A NON COMBUSTIBLE HEARTH MUST BE PROVIDED BENEATH THE APPLIANCE WITHIN THE FIREPLACE OPENING.

A FIRE RESISTING HEARTH MUST ALSO BE PROVIDED SYMMETRICALLY DISPOSED ABOUT THE FIREPLACE OPENING A MINIMUM THICKNESS OF 12 mm WITH THE PERIMETER 50mm ABOVE THE FLOOR LEVEL.

THE WIDTH MUST EXTEND A MINIMUM OF 50mm EITHER SIDE OF THE FIREPLACE OPENING AND A DEPTH OF 300mm FROM THE FRONT OF THE FIREPLACE OPENING.

ANY COMBUSTABLE MATERIAL ABOVE THE OPENING MUST BE REMOVED UP TO A HEIGHT OF 1 METRE ABOVE THE HEARTH LEVEL.

INSTALLATION REQUIREMENTS

SOFT FURNISHINGS

CARE SHOULD BE TAKEN TO PREVENT ANY DAMAGE BEING CAUSED TO SURROUNDING SOFT FURNISHINGS OR DECORATION.E.G MANY EMBOSSED VINYL WALL COVERINGS MAY BECOME DISCOLOURED IF PLACED TOO CLOSE TO THE APPLIANCE.

JEWEL HOLE IN WALL FIRETRAY **WHEN FITTED INTO A BESPOKE FIREPLACE**

THE JEWEL HOLE IN THE WALL CAN BE INSTALLED INTO A BESPOKE FIREPLACE PROVIDING CERTAIN CRITERIA ARE MET AS PER TEST APPROVALS.

THE CRITERIA ARE AS FOLLOWS

ALL MATERIALS USED MUST BE FIREPROOF AND SUITABLE FOR THE PURPOSE INTENDED.

FIRE BOX SIZES

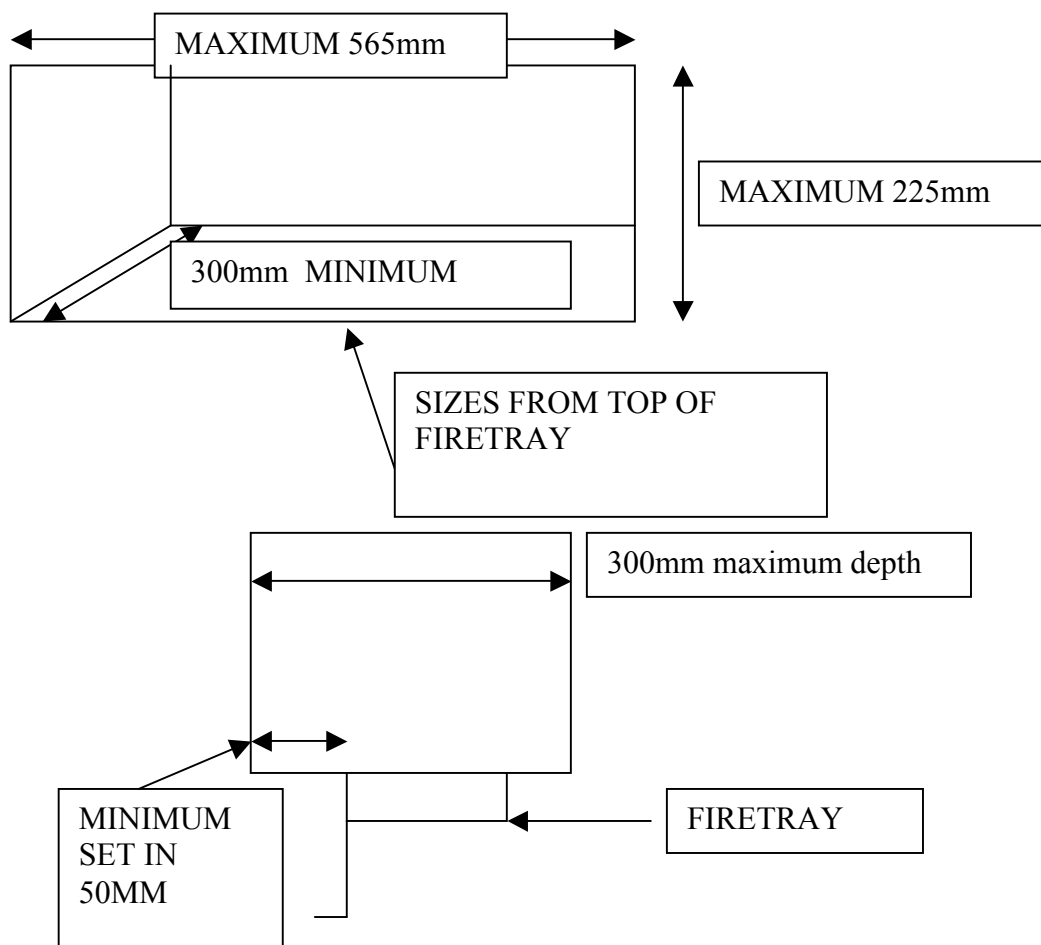

FLUE OUTLET MUST BE MINIMUM 160mm * 355mm

OR

CLASS 1 175mm FLUE LINER/PIPE WITH SPIGOT CONNECTED TO FIRE

OR

**125mm FLUE LINER/PIPE USING CRYSTAL FIRES GATHERHOOD
SEE PAGE 10**

FIRETRAY SIZES FOR BESPOKE INSTALLATION

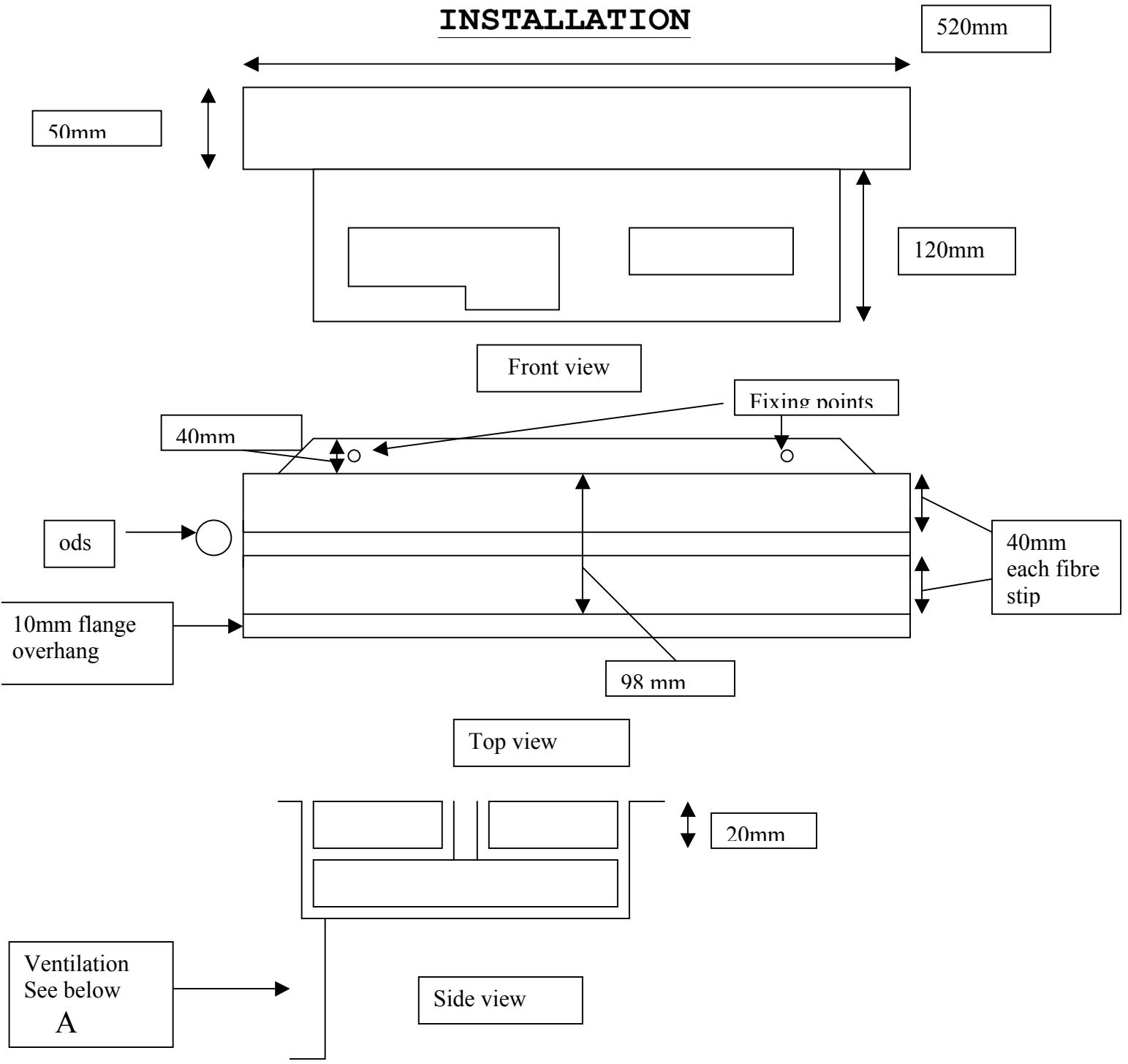

When fitting jewel hole in wall firetray into a bespoke surround, the firetray must be secured in position using two screw holes on rear of tray, Adequate ventilation of a minimum of 60cm² must be allowed to "A" as shown above

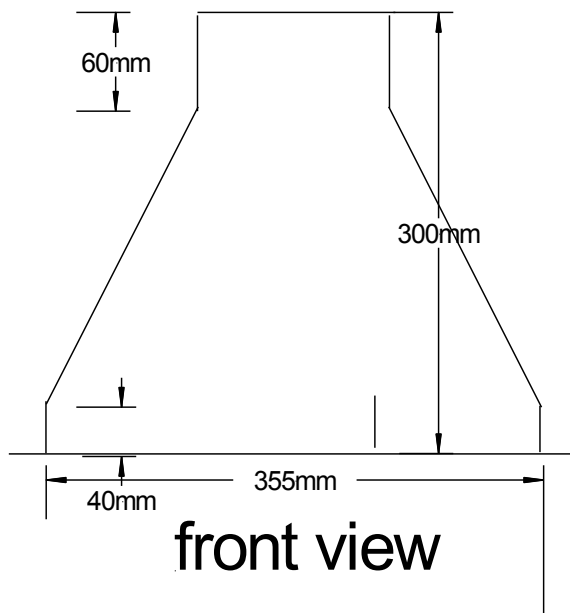
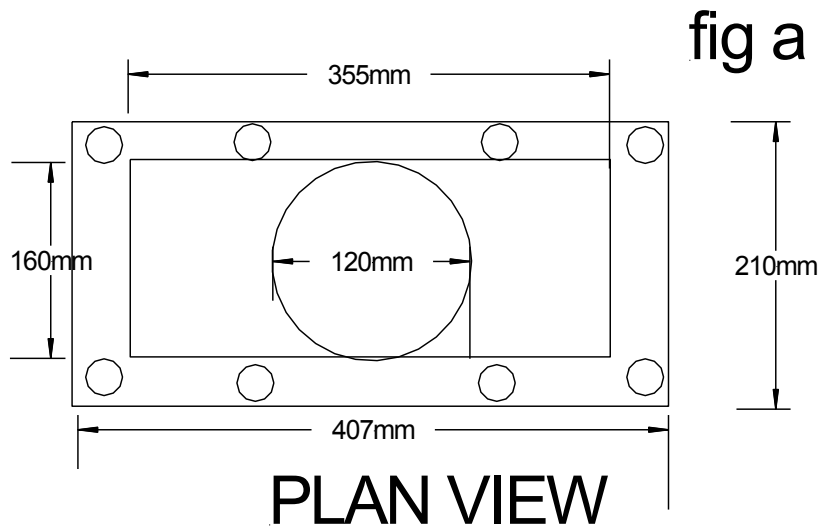

$\pm 3\text{mm}$
JEWEL HOLE IN WALL SPIGOT

TO SUIT 125mm FLUE LINER
 CONNECT FLUE LINER TO FLUE SPIGOT AND SECURE. LEAVE IN
 BUILDERS OPENING 25mm ABOVE TOP OF FIRE BOX.
 INSERT BOX INTO OPENING AND SECURE SPIGOT USING 8
 SELF TAPPING SCREWS SUPPLIED.

INSTALLATION STEPS
CHECK FLUE

CHECK THAT THE CHIMNEY CONFORMS TO THE REQUIRED SPECIFICATIONS AS PREVIOUSLY STATED

EXAMINE THE CONDITION AND CARRY OUT ANY REMEDIAL WORK IF THE FLUE HAS BEEN USED FOR SOLID FUEL IT SHOULD BE SWEEPED AND A SMOKE TEST CARRIED OUT TO CHECK THAT SATISFACTORY SMOKE CLEARANCE HAS BEEN ESTABLISHED

IF ALL THE SMOKE IS NOT DRAWN INTO THE FLUE ,PRE HEAT THE FLUE WITH A BLOW TORCH OR SIMILAR AND RE CHECK.IF THERE IS ANY UNCERTAINTY EXAMINE FOR THE CAUSE AND,IF NECCESARY SEEK EXPERT ADVICE.

GAS SUPPLY

IT IS RECCOMENDED A CONCEALED CONNECTION IS MADE USING RIGID OR SEMI RIGID TUBING, FROM THE REAR OF THE UNIT TAKING INTO ACCOUNT THE REQUIREMENTS OF BS 6891 1988 DEALING WITH ENCLOSED PIPES. A SUITABLE ISOLATING COCK SHOULD ALWAYS BE FITTED IN THE SUPPLY FEED TO THE FIRE TO FACILITATE SERVICING.

SECURE FIRE TO THE FIREPLACE horizon bespoke version

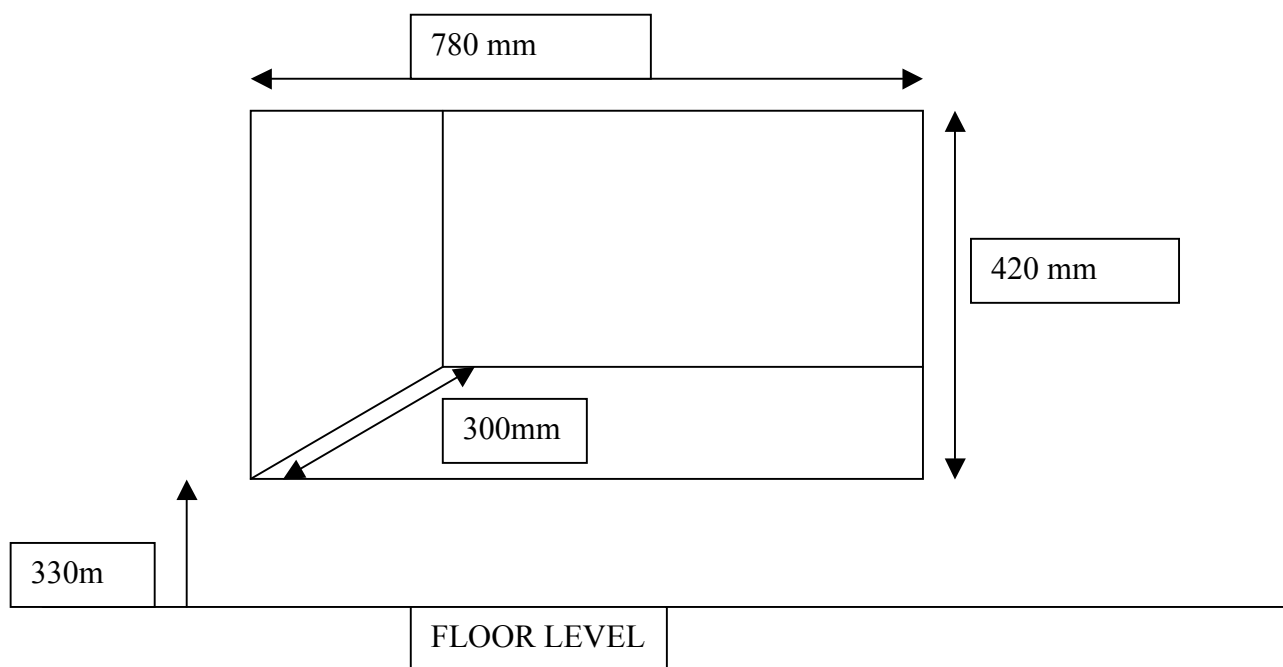

**Make a builders opening to the sizes above
These sizes are the horizon trim bespoke sizes**

MARK POSITION OF FLANGE HOLES, DRILL AND PLUG AND FIX FIRE TO FIREPLACE ENSURING A GOOD SEAL IS MADE BETWEEN FIREBOX AND FIREPLACE USING FOAM SEAL SUPPLIED.

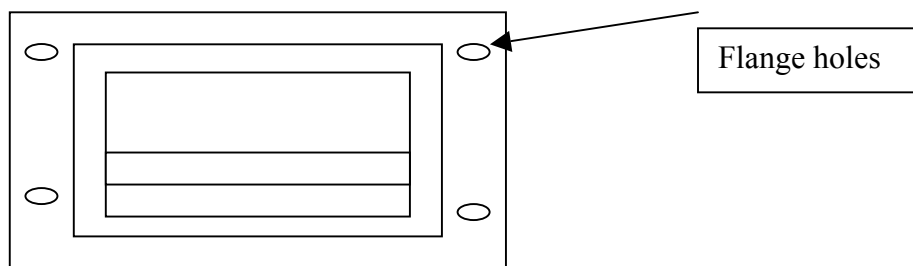

CHECKING GAS PRESSURE AND SOUNDNESS

REMOVE THE PRESSURE TEST POINT SCREW FROM THE INLET ELBOW AND CONNECT PRESSURE GAUGE.

TURN ON GAS TO APPLIANCE.

ROTATE THE CONTROL TO THE IGNITION POSITION AND PUSH IN TO ALLOW THE AIR IN THE PIPEWORK TO BE PURGED.

PUSH IN PIEZO IGNITION SWITCH

CHECK THAT THE ELECTRODE IS SPARKING .

CONTINUE SPARKING UNTIL PILOT IGNITION IS ESTABLISHED.

TURN THE GAS CONTROL KNOB ON TO THE HIGH POSITION AND ALLOW TO RUN FOR FIVE MINUTES.

CHECK THE INLET PRESSURE IS 20 MBAR. +/- 1mbar

CHECK FOR GAS SOUNDNESS.

TURN OFF GAS SUPPLY, DISCONNECT PRESSURE GAUGE AND REPLACE PRESSURE TEST POINT SCREW.

FIT TRIMS

THE JEWEL HOLE IN THE WALL COMES WITH 2 TRIMS PACKED IN SEPARATE BOX. THE FIRST INNER TRIM IS SCREWED TO THE MAIN BOX USING SIX SELF TAPPING SCREWS. 3 TO THE LEFT AND 3 TO THE RIGHT. THE FINAL TRIM FITS TO THE FRONT FLANGE USING MAGNETS ALREADY PLACED ON THE BOX FLANGE.

INSTALLATION STEPS TEST FOR SPILLAGE

CHECK FOR SATISFACTORY CLEARANCE OF COMBUSTION PRODUCTS

CLOSE ALL DOORS AND WINDOWS IN THE ROOM CONTAINING THE FIRE.

TURN ON GAS SUPPLY, LIGHT THE FIRE AND SET THE CONTROLS TO HIGH

LEAVE THE FIRE BURNING FOR FIVE MINUTES AND INSERT A LIGHTED SMOKE MATCH ON A VERTICAL PLANE 50mm INSIDE THE CANOPY AND 180mm FROM EITHER SIDE OF THE OPENING

ALL THE SMOKE MUST BE DRAWN INTO THE FLUE.

IF SPILLAGE OCCURS ALLOW A FURTHER TEN MINUTES.

SHOULD SPILLAGE STILL OCCUR TURN OFF THE FIRE AND SEEK EXPERT ADVICE IF AN EXTRACTOR FAN IS SITUATED IN THE ROOM THIS TEST SHOULD BE REPEATED WITH THE FAN RUNNING

IF THERE IS A CONNECTED ROOM WITH AN EXTRACTOR FAN, THE TEST SHOULD BE REPEATED WITH ALL THE DOORS TO THAT ROOM OPENED AND THE EXTRACTOR FAN RUNNING.

INSTALLATION STEPS

INSTRUCT USER

DEMONSTRATE THE LIGHTING AND EXTINGUISHING PROCEDURES TO THE USER AND REMOVAL AND REFITTING OF THE TRIM FOR CLEANING.

THE CURING EFFECT OF HEATING THE LOGS AND OTHER CERAMICS COMPONENTS WILL CAUSE AN INITIAL ODOUR.

THE APPLIANCE SHOULD BE SERVICED ANNUALLY BY A COMPETENT PERSON IN ACCORDANCE WITH THESE INSTRUCTIONS AND THE APPLIANCE CHECKED FOR SPILLAGE IN ACCORDANCE WITH THE METHOD DETAILED IN THESE INSTRUCTIONS

HAND THESE INSTRUCTIONS TO THE USER.

SERVICING NOTES

GENERAL NOTES.

SERVICING SHOULD BE CARRIED OUT ANNUALLY BY A COMPETENT PERSON SUCH AS A CORGI REGISTERED PERSON IN ACCORDANCE WITH THE RELEVANT REGULATIONS ,TO ENSURE THE SAFE AND CORRECT OPERATION OF THE APPLIANCE

BEFORE COMMENING ANY SERVICE OR REPLACEMENT OF PARTS TURN OFF GAS SUPPLY TO FIRE

AFTER SERVICING CHECK FOR GAS SOUNDNESS

AT LEAST ONCE A YEAR CHECK FOR DEBRIS

IF SOOT HAS ACCUMULATED CHECK TO ESTABLISH CAUSE AND RECTIFY IF NECCASARY CLEAN FLUE OR CHIMNEY ACCORDINGLY

EXAMINE THE FUEL FOR SIGNS OF CRACKING AND REPLACE IF NECCESARY.SEE FUEL LAYOUT PROCEDURE BEFORE ATTEMPTING TO REPLACE FUEL WHICH SHOULD ONLY BE REPLACED AS A COMPLETE SET WITH NO EXTRA FUEL ADDED

1 REMOVAL OF FUEL IF FITTED

REMOVE LOOSE FUEL

2REPLACEMENT OF GAS CONTROL

REMOVE FUEL SET AS 1

DICONNECT FIRE AT INLET ELBOW

REMOVE FIRE TRAY BY UNSCREWING TWO SCREWS AT FRONT BOTTOM SECTION OF FIRE TRAY

REMOVE CONTROL KNOB,DISCONNECT GAS CONNECTIONS TO VALVE INCLUDING PILOT CONNECTIONAND THERMOCOUPLE CONNECTION

REMOVE LOCKNUT HOLDING GAS CONTROL TO FRONT BOTTOM SECTION

RE ASSEMBLE IN REVERSE ORDER

TURN ON GAS SUPPLY,CHECK FOR SOUNDNESS AND RE COMMISION APPLIANCE

3 REPLACEMENT OF INJECTOR

REPEAT 2 REMOVE GAS CONTROL

DISCONNECT GAS CONNECTIONS TO INJECTOR

UNSCREW INJECTOR WHILST AT THE SAME TIME HOLDING THE LOCKNUT

WITH A SPANNER AND CLEAN OR REPLACE

RE ASSEMBLE IN REVERSE ORDER

TURN ON GAS SUPPLY .CHECK FOR SOUNDNESS AND RECOMMISSION THE APPLIANCE

4 REPLACEMENT OF OXY-PILOT ASSEMBLY

DISCONNECT FIRE AT INLET ELBOW

REMOVE FIRETRAY BY UNSCREWING 5 SCREWWS AT FRONT OF TRAY AND TWO AT BACK

DISCONNECT THERMOCOUPLE FROM GAS VALVE

DISCONNECT GAS CONNECTION FROM PILOT ASSEMBLY

REMOVE IGNITOR LEAD FROM PILOT ASSEMBLY

UNDO SCREWS SECURING OXY-PILOT TO FIRETRAY

RE-ASSEMBLE IN REVERSE ORDER

TURN ON GAS SUPPLY, CHECK FOR GAS SOUNDNESS AND RE-COMMISSION APPLIANCE.

CRYSTAL FIRES ODS SERVICING GUIDE

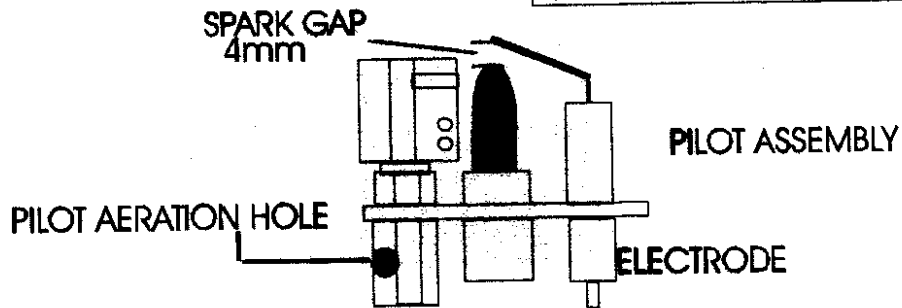
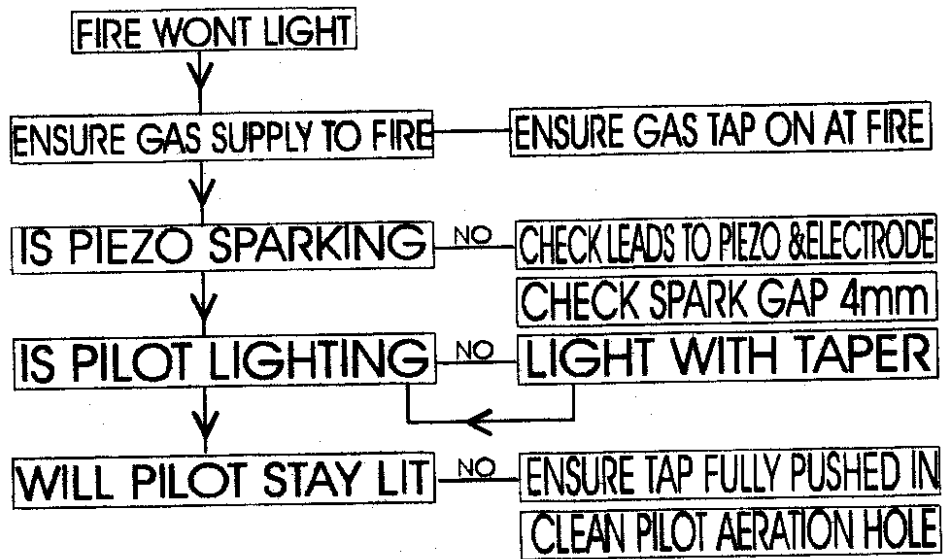

IF FOR ANY REASON FIRE WILL NOT STAY LIT OR GOES OUT AFTER A SHORT PERIOD THE MAIN CAUSE IS DUST IN THIS HOLE, PETS SUCH AS DOGS OR CATS WILL MAKE DUST IN THIS HOLE MORE LIKELY.

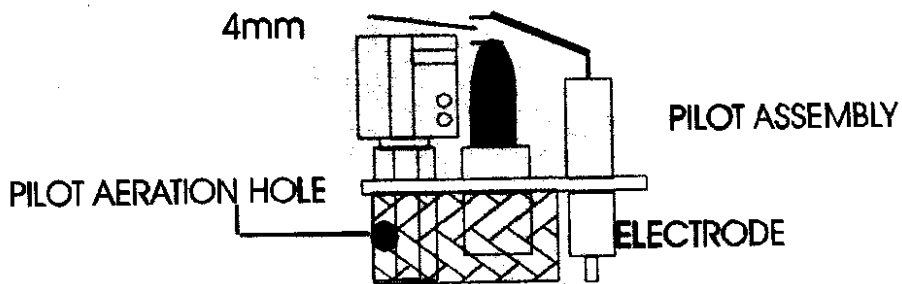

IF LINT ARRESTER IS FITTED (SHOWN) THIS WILL HAVE TO BE REMOVED CLEANED AND REPLACED.



BECHERS DRIVE
AINTREE RACECOURSE
BUSINESS PARK
AINTREE
LIVERPOOL
L9 5AY

JEWEL
HOLE IN THE WALL
DECORATIVE FUEL EFFECT GAS FIRE
Horizon trim version

THIS APPLIANCE IS CAT I_{2H}
FOR USE WITH NATURAL GAS
ONLY
G20 AT 20mbar
IN G.B. AND I.E.

USERS INSTUCTIONS

**IT IS HIGHLY RECCOMENDED
A
FLUE LINER IS INSTALLED
WITH THIS
APPLIANCE IF THE FLUE IS
NOT NEW**

IF A FLUE LINER IS NOT INSTALLED WITH THIS APPLIANCE WE HIGHLY RECOMMEND THE BURNER IS INSPECTED FOR DEBRI ON A WEEKLY BASIS AND IF NECCESARY REMOVE AS REQUIRED.

IF DEBRI CONTINUES SEEK EXPERT ADVISE

USERS INSTRUCTIONS FOR JEWEL GAS APPLIANCE

YOUR JEWEL GAS APPLIANCE IS A DECORATIVE LIVE FUEL EFFECT GAS FIRE ,DUE TO ITS NEWNESS THE FIRE MAY GIVE OFF SLIGHT SMELL FOR A SHORT PERIOD AFTER INSTALLATION .THIS IS QUITE NORMAL AND WILL DISAPPEAR AFTER A FEW HOURS OF OPERATION. THE APPLIANCE TO WHICH THESE INSTRUCTIONS APPLY MUST BE INSTALLED BY A COMPETENT PERSON(EG. A C.O.R.G.I MEMBER IN ACCORDANCE WITH THE CURRENT EDITION OF THE GAS SAFETY INSTALLATIONS AND USE REGULATIONS OR THE RULES IN FORCE)APPROVED BY THE HEALTH AND SAFETY EXECUTIVE AND MUST BE IN ACCORDANCE WITH THE INSTALLATION AND SERVICING INSTUCTIONS SUPPLIED.

SERVICING SHOULD BE CARRIED OUT REGULARLY BY A COMPETENT PERSON (EG A C.O.R.G.I MEMBER)IN ACCORDANCE WITH THE CURRENT EDITION OF THE GAS SAFETY (INSTALLATION AND USE) REGULATIONS OR THE RULES IN FORCE.TO ENSURE THE CORRECT AND SAFE OPERATION OF THE APPLIANCE .DEBRIS SHOULD ALSO BE REMOVED FROM BEHIND THE APPLIANCE AT REGULAR INTERVALS.

BEFORE INSTALLATION OF THE APPLIANCE THE CHIMNEY MUST BE SWEPT AND THEN INSPECTED REGURLARLY TO ENSURE THAT IT REMAINS FREE OF OBSTRUCTION.

A FIRE GUARD COMPLYING TO BS8423 ,MUST BE FITTED IF THE ROOM WILL BE OCCUPIED BY YOUNG CHILDREN THE ELDERLY ,OR INFIRM PEOPLE. ON NO ACCOUNT MUST ANY RUBBISH BE THROWN ON TO THE FIRE OR THE LAYOUT OF THE FIREBED DISTURBED.

**THE LOWER HINGED TRIM MUST BE LOWERED
INITIALLY TO LIGHT THE PILOT LIGHT AND THEN
REPLACED BEFORE TURNING APPLIANCE TO ON
POSITION**

**OPERATING INSTRUCTIONS
MERTIK MAXITROL REMOTE CONTROL SYSTEM**

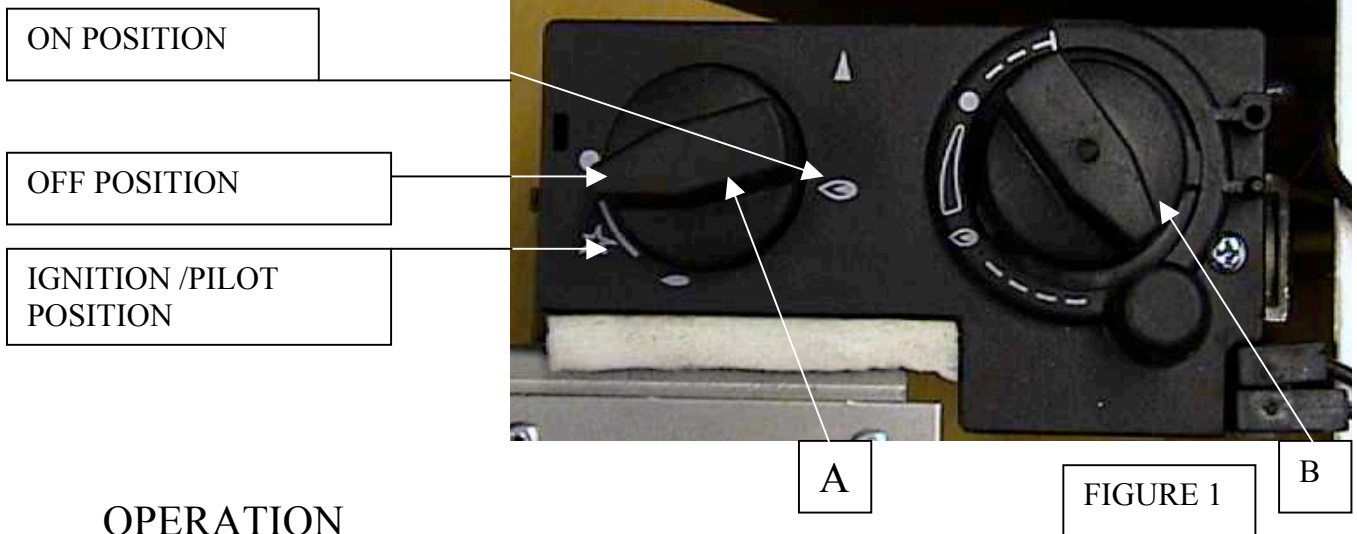

OPERATION

LIGHTING PROCEDURE

1. TURN KNOB A (FIGURE 1) SLIGHTLY LEFT TOWARDS THE IGNITION POSITION(SHOWN IN FIG 1 ABOVE) UNTIL REACHING STOP,PRESS DOWN AND HOLD FOR FIVE SECONDS
(ONLY PILOT GAS FLOWS)
2. CONTINUE PRESSING DOWN KNOB A WHILE TURNING FURTHER LEFT TO ACTIVATE PIEZO,CONTINUE TO HOLD DOWN FOR 10 SECONDS AFTER PILOT HAS BEEN LIT,IF PILOT DOES NOT LIGHT,STEPS 1 AND 2 CAN BE REPEATED IMMEDIATELY.
3. UPON LIGHTING,RELEASE KNOB A AND TURN FURTHER LEFT TO ON POSITION (SHOWN IN FIGURE 1 ABOVE)PILOT GAS FLOWS AND MAIN BURNER FLOWS IN ACCORDANCE TO THE FLAME SETTING(KNOB B AS SHOWN IN FIG 1 ABOVE)

ADJUSTING THE FLAME SETTINGS

TO TURN THE FIRE ON AND/OR TO ADJUST THE FLAME STTING, PRESS THE ON BUTTONS ON THE REMOTE HANDSET.CONTINUE PRESSING UNTIL DESIRED FLAME SETTING IS OBTAINED.PRESS AND HOLD THE OFF BUTTON TO REVERSE THE SETTING.THE RECEIVER IS EQUIPPED WITH A BUILT IN DELAY, RECOGNIZABLE BY THE FLICKERING LIGHT,TO FACILITATE FINE ADJUSTMENT OF THE FLAME
THE MOTORIZED VALVE IS EQUIPPED WITH A SLIP CLUTCH ,ALLOWING MANUAL ADJUSTMENT OF MAIN GAS BY TURNING KNOB B

ON BUTTONS
TO PRESS THE ON BUTTON YOU MUST PRESS THE 2 BUTTONS TOGETHER

OFF BUTTON

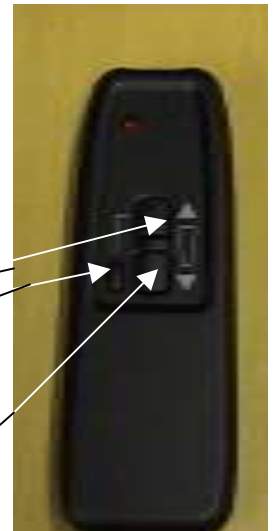

SHUT OFF PROCEDURE

- 1.TURN KNOB A RIGHT UNTIL REACHING STOP. IN THIS POSITION ONLY PILOT GAS FLOWS
- 2.TO SHUT OFF VALVE COMPLETELY,PRESS DOWN SLIGHTLY AND CONTINUE TURNING RIGHT FROM PILOT POSITION TO THE OFF POSITION.THE SAFETY INTERLOCK PREVENTS RE-IGNITION OF THE PILOT FLAME UNTIL THERMOCOUPLE HAS COOLED DOWN SUFFICIENTLY(ELAPSED TIME WILL VARY BASED ON THERMOCOUPLE TYPE)
- 3.SWITCHING OFF THE REMOTE IS NOT NECESSARY.



THE SENSOR AND BATTERY HOLDER A INSERTED BENEATH THE RIGHT SIDE OF THE FIRE.TO REPLACE BATTERIES ALLOW FIRE TO COOL FOR AT LEAST 30 MINUTES THEN PULL OUT BATTERY HOLDER, THE COVER CAN SLIDE OFF AS ABOVE AND THE BATTERIES CAN BE REPLACED.(USE ONLY LIKE FOR LIKE ALKALINE AA BATTERIES)

REPLACEMENT PARTS

BATTERY HOLDER AND SENSOR

CRYSMERTIKHOLDER

GAS VALVE

CRYSMERTIKVALVE

REMOTE HANDSET

CRYSMERTIKHANDSET

INSTALLATION INFORMATION

GAS SUPPLY: THE GAS CONNECTION CAN BE FROM EITHER THE LEFT OR RIGHT HAND SIDE OF THE FIRE.ENSURE THAT THE GAS PIPE DOES NOT PREVENT THE REMOVAL OF THE BATTERY HOLDER AND SENSOR OR ACCESS TO OPERATE THE GAS CONTROL KNOBS

LIGHTING WITH A TAPER

IF IGNITION FAILS, THE APPLIANCE CAN BE LIT WITH A TAPER BY TURNING THE CONTROL KNOB TO THE IGNITION POSITION ,KEEP IT PRESSED IN AND LIGHT THE PILOT ON THE LEFT HAND SIDE WITH A TAPER AND THEN FOLLOW THE OPERATING INSTRUCTIONS FROM ABOVE.

LIGHTING WITH A TAPER IS ONLY A TEMPORARY MEASURE AND A SERVICE CALL TO RECTIFY THE FAULT MUST BE DONE AS SOON AS POSSIBLE.

CLEANING

BEFORE CLEANING ANY PART OF THE FIRE ,ENSURE THAT THE GAS IS
TURNED OFF AND FIRE IS COOL

COAL BED LAYOUT

PERIODICALLY SMALL DEPOSITS OF SOOT MAY GATHER ON THE FUEL
BED AND BURNER, THIS MUST BE REMOVED BY REMOVING FUEL AND
BRUSHING ANY DEPOSITS WITH A SOFT BRUSH AND VACUUMING THE
BURNER, THEN REPLACE FUEL USING THE FOLLOWING PROCEDURE.

THIS APPLIANCE IS DESIGNED TO BE INSTALLED WITHOUT ANY FUEL
PIECES HOWEVER ANY CERAMIC FUEL MAY BE USED WITH THE JEWEL
HOLE IN THE WALL AS A DECORATIVE MEASURE ONLY ,AND
**MUST NOT IMPINGE THE FLAMES IN ANY WAY,THE DECORATIVE
FUEL MAY BE PLACED ONLY AS DIRECTED BELOW**

**ANY FUEL PIECES MUST ONLY BE THE WIDTH OF THE BURNER IN
TOTAL AND NO HIGHER THAN 80mm**

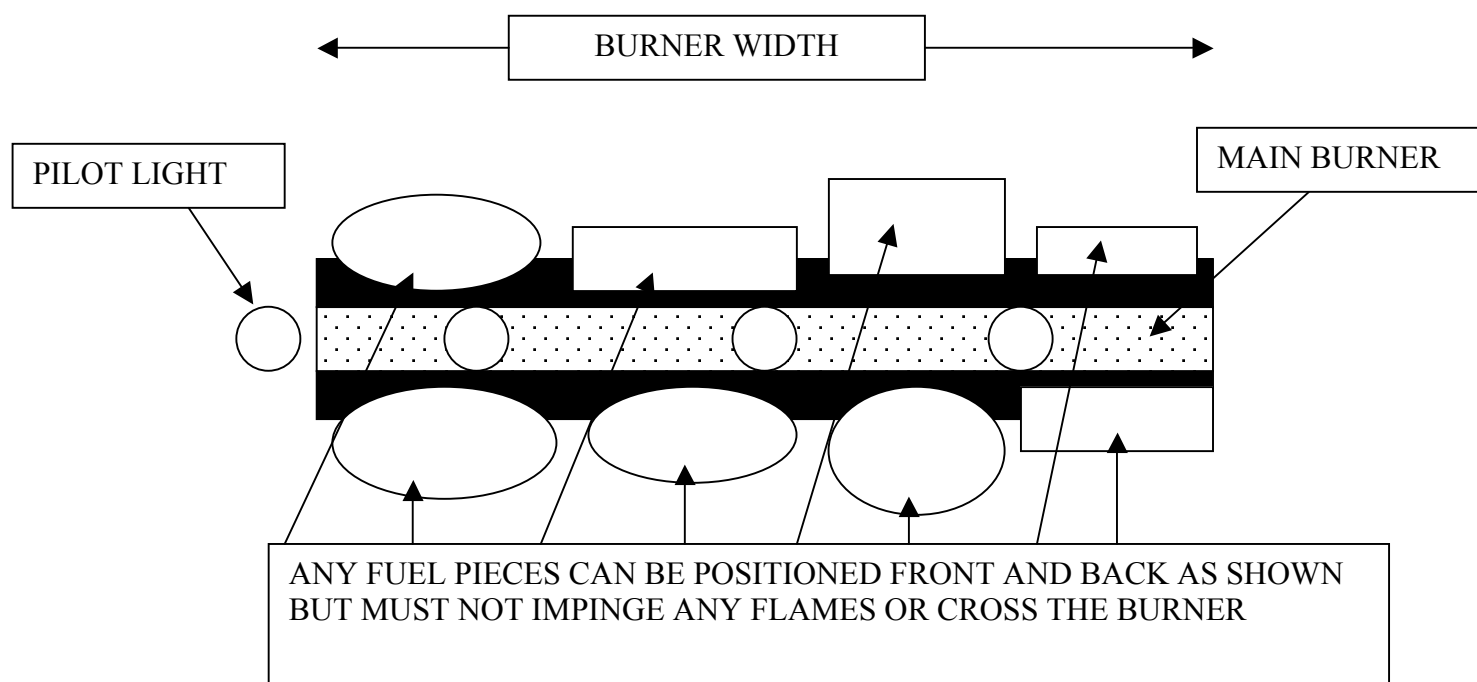

AS SHOWN CORRECTLY ABOVE

SHOWN INCORRECT BELOW

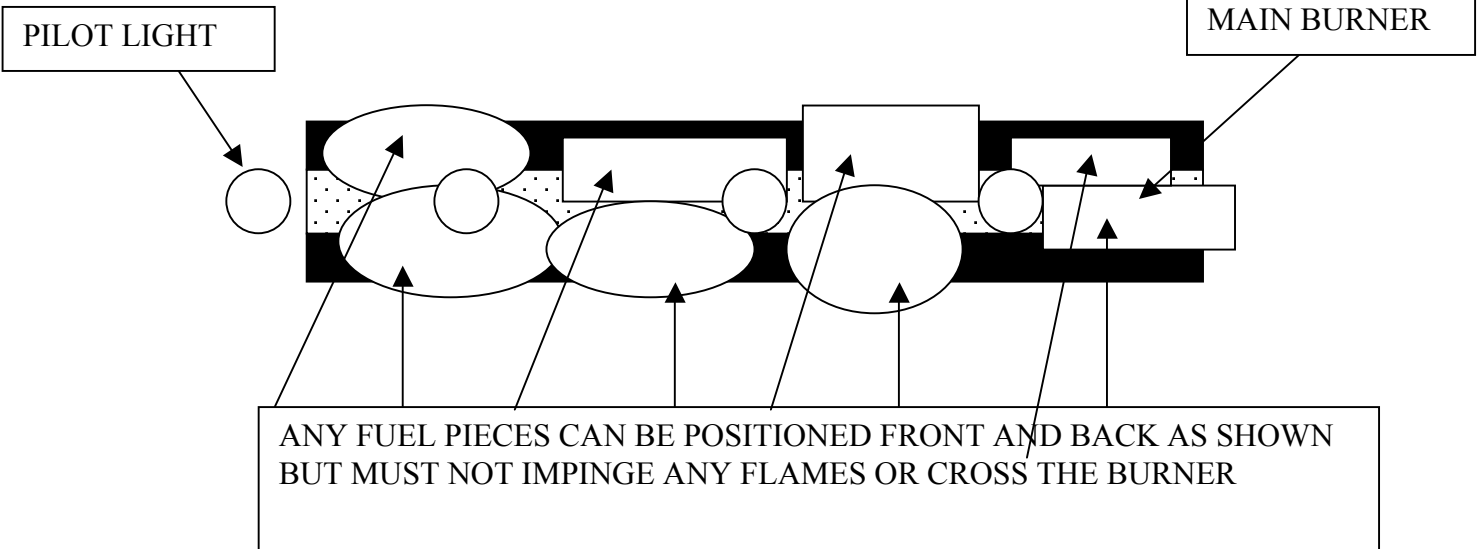

INCORRECT ABOVE AS SHOWN AS THE FUEL PIECES ARE CROSSING THE BURNER

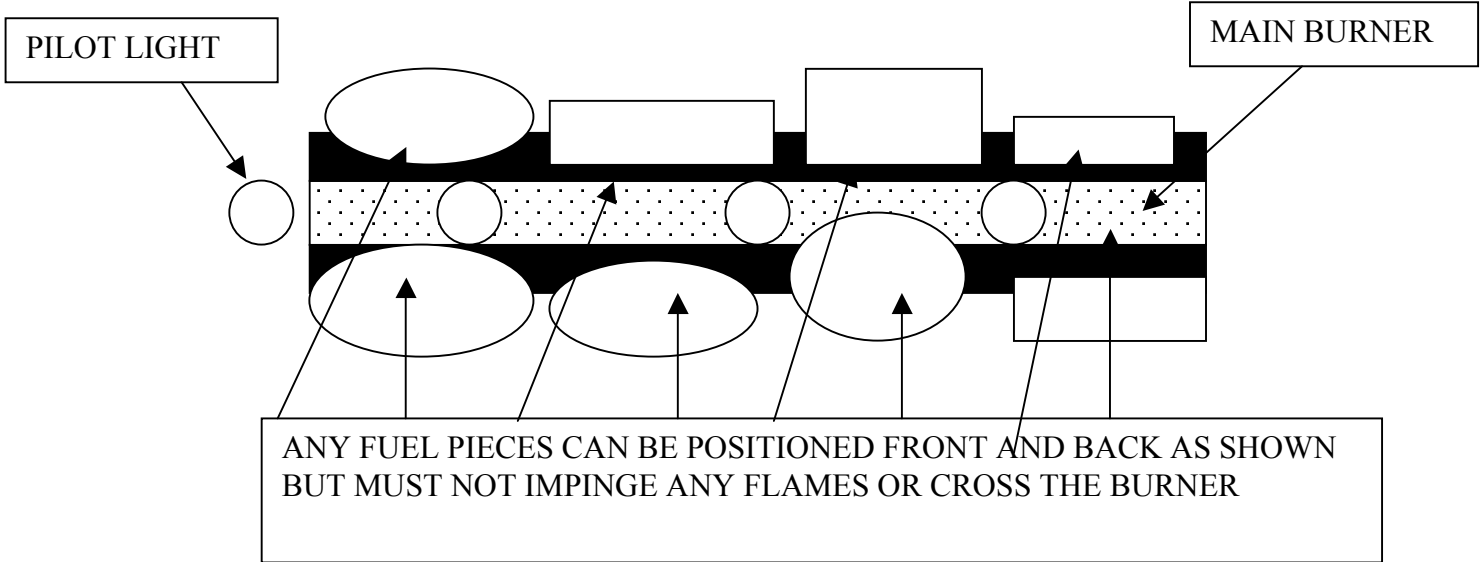

INCORRECT AS SHOWN ABOVE ONE FUEL PIECE IS CROSSING THE BURNER AND IMPINGING THE FLAME